

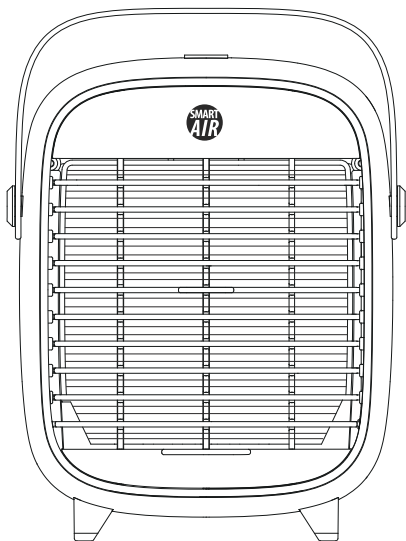

QT3



3 in 1
Portable • Fan • Air Purifier

Small, but mighty

We wanted to create a fan-air purifier that brings you cool, clean air and is portable enough to bring on the go.

The QT3 is small enough to place on any table, but powerful enough to provide a clean air bubble up to 1.2m away. Perfect for getting clean air in your life.

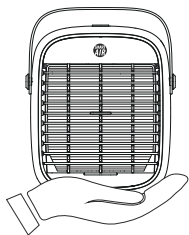

Features

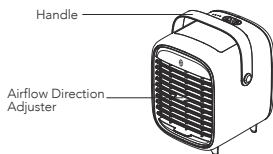

Front View

Travel version only:



Battery

Approximately 3 hours to charge completely

Battery life based on fan speed

High Speed	-> ~2 hours
Medium Speed	-> ~3 hours
Low Speed	-> ~4 hours

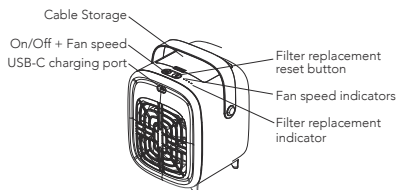

Rear View

About Smart Air

Smart Air is a social enterprise and certified B-corp dedicated to distributing cost-effective air purifiers and providing open-source data and science to combat the harms of air pollution.

Learn more:

Certified



Corporation



Turning on Your QT3

Follow these steps to start breathing cool, clean air with your QT3:

Step 1: Open the HEPA Filter bag

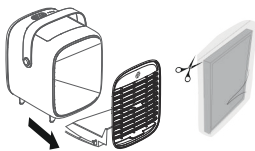

Pull out the front tray from your QT3. Remove the HEPA filter and open the bag

Step 2: Plug in the supplied USB-C cable, and connect it to a USB power source.

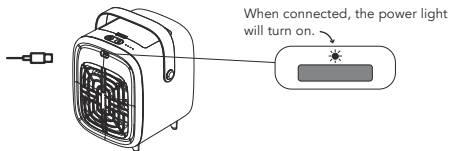

Home version: a blue light indicates power is connected

Travel version: a blue light indicates battery is fully charged, a red light indicates battery is charging.

Step 3: Press the fan button to adjust the fan speed.

The indicator lights will show the fan speed:

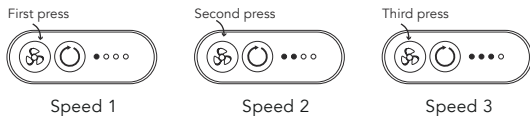

Stuff Our Lawyers Made Us Say (Important Safety Instructions)

1. Do not stick your fingers into the fan.
2. Remove the USB cable and turn the purifier off before replacing the filter.
3. Children under 12 years should not use this purifier without supervision.
4. Store the product in a clean and dry place.

Replacing the HEPA filter

1. The filter replacement indicator will flash continuously when your HEPA filter needs replacing:



2. Pull out the air purifier's front tray then lift out the old HEPA filter.

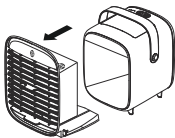

3. Remove your new HEPA filter from its bag.



4. Insert your new HEPA filter firmly into the front tray. Ensure the arrow on the filter points outwards.

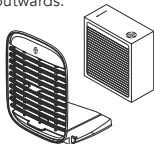

5. After inserting the front tray back into your purifier, hold the filter replacement button for 2s. This resets the filter replacement light.

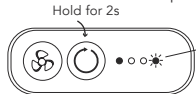

The filter replacement indicator will flash rapidly 3 times to indicate it has been reset.

Note: the filter indicator light will illuminate after your fan purifier has been running for approximately 800 hours. For more information on how this number varies based on your usage, visit: <https://smartairfilters.com/QT3-replacement>



Product Information

Product No.: SA200
Material: ABS/PP/PC electronic component
Input voltage: DCSV/Type-C electronic component
Input current: 1A
Working power: 9W Max
Standard: / GB4706.1-2005 / GB4706.27.2008 / GB4706.45-2008
Quality Inspection: PASSED

Home version:
Product Weight: 610g

Travel version:
Product Weight: 655g
Battery Voltage: 3.7V
Battery Capacity: 2000mAh



Read this manual in your language:
scan the QR code!

要更多语言吗？扫二维码！

QR кодыг уншуулсанаар та ашиглах
зааврыг өөрийн хэлээр унших боломжтой!



smartairfilters.com