



The Sqair Air Purifier

Clean Air Is Not A Luxury.

Story behind The Sqair

The world doesn't need another purifier company that overcharges you for clean air. The Sqair is a purifier that's been stripped down to its active ingredients: a fan and a filter. That's all you need to breathe clean air.



Minimalist
design



Energy
efficient



Extremely
quiet

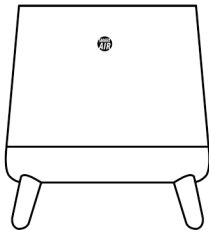

About Smart Air

Smart Air is a social enterprise and certified B Corp dedicated to distributing cost-effective air purifiers and providing open-source data and science to combat the harms of air pollution.

Certified



What's inside The Sqair?

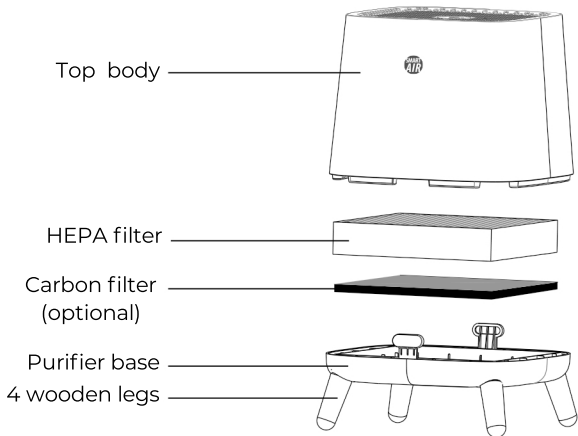

Not everyone needs a carbon filter.
Scan to find out if you do.



Setting up The Sqair

Before you start breathing clean air, you'll need to get your Sqair ready for action. Here's how:

Step 1: Attach the legs

Screw the four wooden legs, in a clockwise direction, into the four screws in the base of the purifier.

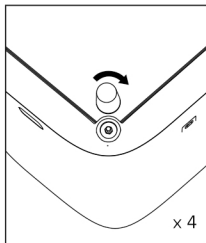

Step 2: Set up your filters

1. Press the side buttons and lift the top body.

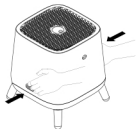

 Be careful not to trap your fingers!

2. Remove the bags from the HEPA filters.

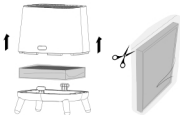

3. Insert the filters, making sure the arrows are in the right direction.

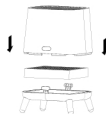

Note: If you're using a carbon filter, make sure you insert it in the right order: Carbon filter (bottom) → HEPA filter (top)

Turning on The Sqair

After inserting the filters, you're ready to power up.

1. Plug in your power cable
2. Rotate the dial on top to turn on your Sqair

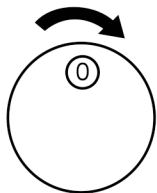

The Sqair has 3 speeds. Here's what they do:

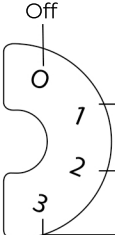
	Speed	Particulate CADR	Noise Level*	Power Usage	Room size cleaned in 60 minutes
	1	65m ³ /hr (38cfm)	23dB(A)	6W	4-7m ² (43-75ft ²)
	2	180m ³ /hr (106cfm)	40dB(A)	18W	12-21m ² (129-226ft ²)
	3	300m ³ /hr (177cfm)	52dB(A)	38W	21-36m ² (226-388ft ²)

*Sound Pressure Level

Note: If you're using a carbon filter in your Sqair, performance will vary. For full info, check out smartairfilters.com/sqair

How to replace your filters

You should replace your filters regularly to make sure your Sqair is working as efficiently as possible.

For an average usage of 8 hours per day, we recommend changing your HEPA filter every 2-5 months.



1. Remove the power cable.

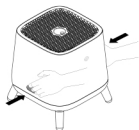

2. Press the side buttons and lift the top body.

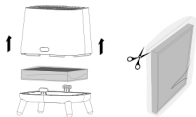

3. Remove and replace the filters, taking note of the direction arrow on your filters.



4. Reassemble and plug your Sqair back in.

If you want to estimate the frequency of replacing HEPA filters based on your personal usage, please visit:
<https://smartairfilters.com/en/when-change-hepa-filter/>



FAQ

Question

Answer

Can I wash my HEPA filter?

We've run tests that show washing HEPA filter doesn't work. Check out this answer:



Where can I get replacement filters?

Head to smartairfilters.com/en/product/sqair-hepa-filter/ for a full list, or scan the QR code:



Product Information v1.2

Product No.: SA120

Dimensions: 333mm x 333mm x 365mm

Recommended Coverage Area: 21-36m²

Power: 38W

Voltage: 220-240V~

Filter: H12

Particulate CADR: 300m³/hr

Noise: 23-52dB(A)

Material: ABS Plastic

Net Weight: 4kg

READ AND SAVE THESE INSTRUCTIONS

Read this user manual carefully before you use your Sqair, and be sure to save it for future reference.

Danger

- DO NOT let water or any other liquid or flammable detergent enter The Sqair to avoid electric shock and/or a fire hazard.
- DO NOT clean Sqair with water or any other liquid or a (flammable) detergent to avoid electric shock and/or a fire hazard.

Warning

- Ensure the voltage indicated on the back of the purifier corresponds to your mains voltage.
- If the supplied cable is damaged, you must have it replaced by distributor, or a service center authorized by distributor or similarly qualified persons in order to avoid a hazard.
- DO NOT use Sqair if the plug, the mains cable or the machine itself is damaged.
- This appliance can be used by children aged from 8 years and above and persons with reduced physical, sensory or mental capabilities or lack of experience and knowledge if they have been given supervision or instruction concerning use of the appliance in a safe way and understand the hazards involved.
- Children shall not play with the appliance.
- Cleaning and user maintenance shall not be made by children without supervision.
- Do not block the air inlet and outlet, e.g. by placing items on the air outlet or underneath the purifier at the inlet.
- Always turn off the unit before unplugging it to prevent the risk of electric shock.

Caution

- This purifier is not a substitute for proper ventilation, regular vacuum cleaning or use of an extractor hood or fan while cooking.
- If the wall socket used to power the purifier has poor connections, the plug may become hot. Make sure you plug the appliance into a properly connected wall socket.
- Always place and use the appliance on a dry, stable, level and horizontal surface.
- Leave at least 15cm free space behind and on all sides of the purifier and leave at least 40cm free space above the appliance.
- DO NOT place anything on top of the purifier and do not sit on the purifier.
- DO NOT place the purifier directly below an air conditioner to avoid condensation from dripping onto the appliance.
- Make sure all filters are properly installed before you switch on the appliance.
- Avoid knocking against the purifier (the air inlet and outlet in particular) with hard objects.
- Always use both hands to lift Sqair when moving or replacing filters.
- DO NOT insert your fingers or objects into the air outlet, even when your Sqair is powered off.
- DO NOT use this purifier when you have used indoor smoke-type insect repellents or in places with oily residues, burning incense or chemical fumes.
- DO NOT use the purifier near gas appliances, heating devices or fireplaces.
- Always unplug the purifier after use and before you clean it or change the filters.
- DO NOT use the purifier in a room with major temperature changes, as this may cause condensation inside the appliance.
- The purifier is only intended for household use under normal operating conditions.
- DO NOT use the purifier in wet surroundings or in surroundings with high ambient temperatures, such as the bathroom, toilet or kitchen.
- The purifier does not remove carbon monoxide (CO).
- It cannot be used as a safety device in case of accidents with combustion processes and hazardous chemicals.



Correct Disposal of this product

This marking indicates that this product should not be disposed with other household wastes throughout the EU. To prevent possible harm to the environment or human health from uncontrolled waste disposal, recycle it responsibly to promote the sustainable reuse of material resources. To return your used device, please use the return and collection systems or contact the retailer where the product was purchased. They can take this product for environmental safe recycling.

Want to learn more about
Smart Air products?

Feel free to scan the QR code!



smartairfilters.com